

HOLIDAY SEASON 10K
EAST POTOMAC PARK
WASHINGTON, DC

MAP NOT TO SCALE

USATF-CERTIFIED
COURSE
DC-11002-RT

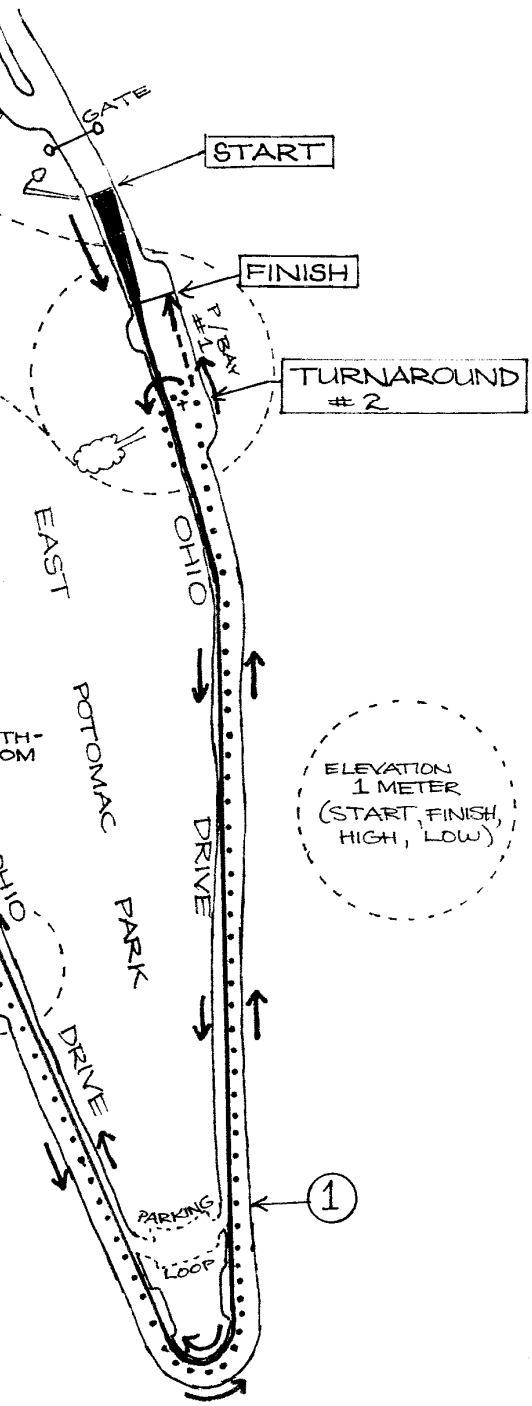
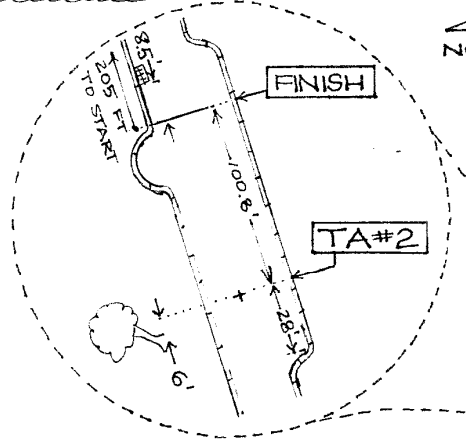

LOCATIONS
START: AT FIRST LIGHT POLE SOUTH OF GATE; 106 FT S OF GATE
TURNAROUND #1 & 3: PKG BAY #18, BESIDE 11TH SPACE FROM S END; 248 FT N OF S END OF PB 18; 24 FT N OF L/POLE, W SIDE.
TURNAROUND #2: 28 FT N OF S END, P/BAY #1; 100.8 FT S OF FINISH; 6 FT N OF SYCAMORE ON LAND SIDE WITH WHITE TRUNK.
FINISH (AFTER 2 OUT-BACKS): 205 FT S OF START, AT CURB JOINT IMMED. NORTH OF "WIDEOUT" IN P/BAY #1; 8.5 FT SOUTH OF STORM DRAIN.
1 MI: AT N EDGE OF STORM DRAIN TO IMMED. NORTH OF PARKING LOOP ENTRANCE; 61 FT N OF "NOSE" OF PKG LOOP ENTRANCE.
NOTE: POINTS MARKED "P"

ELEVATION
1 METER
(START, FINISH,
HIGH, LOW)

KEY
 ——— PATH TO TA1
 PATH TO TA2, TA3, TA2
 - - - TO FINISH AFTER TWO OUT-BACKS

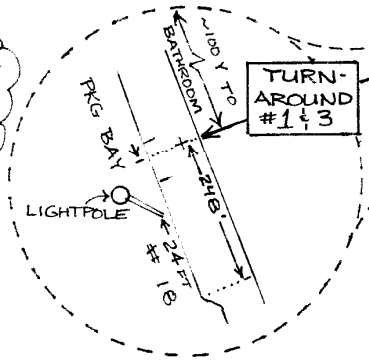

DOUBLE OUT-AND-BACK COURSE
 1. START TO TURNAROUND #1
 2. RETURN TO TURNAROUND #2
 3. RETURN TO TURNAROUND #3
 4. RETURN TO FINISH.

MEASUREMENT
22 JANUARY 2011 BY R THURSTON
CERTIFICATION
IN EFFECT 8 FEB 2011 TO 31 DEC 2021

RET